

DRINKS | Drink Cabinets

DRINK COOLER ▶ UPRIGHT COOLERS

RCF 145

CUSTOMIZATION AVAILABLE
PERSONALIZZAZIONE DISPONIBILE



| | | | | | |
|-------|-----|--------------|-------------------|-----|---------------|
| 45 mm | K4 | +1°C +9°C | C ENERGY CLASS | CC2 | +32°C 65RH |
| LED | Key | Water | Compressor | Fan | GAS R600a |

DETAILS

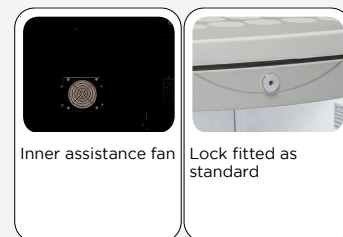

GENERAL FEATURES

- 115 Lt. Upright drink cooler
- External in white coated plate, white thermoformed internally
- Roll-bond evaporator system with fan assisted cooling
- Manual Defrost
- Foaming Agent Cyclopentane (45mm per side)
- Removable Gasket
- Independent switch for internal light
- Double layer safety tempered glass (Curved)
- Digital thermometer
- Reversible door
- Lock fitted as standard
- Adjustable shelves (White Color): 3 Pcs
- N.4 Adjustable feet
- Energy efficiency class: C

TECHNICAL SPECIFICATIONS

| | |
|----------------------------------|----------------|
| Capacity | 115 L |
| Temperature | K4 (+1°C-+9°C) |
| Consumption | 2.76 kWh/24h |
| Rated Power | 90 W |
| Noise level | 47 dB(A) |
| Net Weight | 37 Kg |
| Gross Weight | 40 Kg |
| External Dimensions (WxDxH mm) | 505x590x855 |
| Internal Dimensions (WxDxH mm) | 410x395x700 |
| Packaging dimensions (WxDxH mm) | 580x620x880 |
| Loading quantities 20'/40'/40'HQ | 72/158/220 |

PRODUCT DIMENSIONS

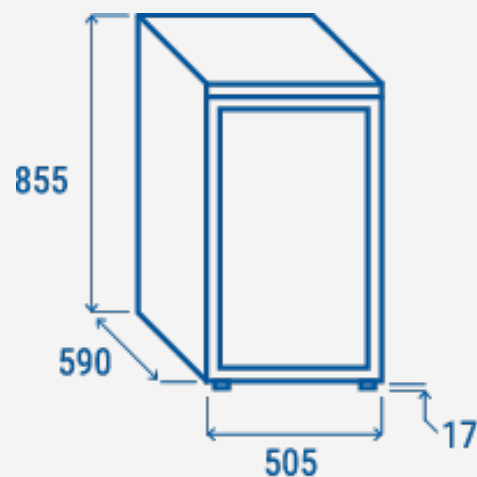

CERTIFICATION

CE RoHS

